

Cub Cadet

Power Equipment

SERVICE ADVISORY

TO: ALL CUB CADET DEALERS

FROM: CUB CADET SERVICE

DATE: APRIL 24, 1992 [REVISED JUNE 17, 1992]

SUBJECT: ADAPTING DECKS

IN MODEL YEAR 1992 THE GARDEN AND SUPER GARDEN TRACTORS HAD SEVERAL CHANGES THAT AFFECTED THE ATTACHING OF 1991 AND OLDER DECKS. THE PULLEY ON THE ELECTRIC CLUTCH WAS MADE LARGER FOR A BETTER MULE DRIVE BELT LIFE AND THE FRONT END OF THE GARDEN TRACTORS WAS RAISED TO PROVIDE ADDITIONAL CUTTING HEIGHT.

IN ORDER TO USE DECKS MANUFACTURED IN 1992 ON GARDEN TRACTORS AND SUPER GARDEN TRACTORS MANUFACTURED IN 1991 OR BEFORE (SERIAL NO. 800,000 TO 821,059) IT IS NECESSARY TO CHANGE THE DECK PULLEY, DECK LINKS AND V-BELT. SEE THE ATTACHED CHART FOR SPECIFIC PART NUMBERS.

NOTE

FAILURE TO DO THIS WILL RESULT IN A POOR
QUALITY OF CUT SINCE THE BLADE TIP SPEED
WILL BE REDUCED.

IN ORDER TO USE DECKS MANUFACTURED IN 1991 AND PRIOR ON GARDEN TRACTORS AND SUPER GARDEN TRACTORS MANUFACTURED IN 1992 (SERIAL NO. 821,101 & HIGHER) IT IS NECESSARY TO CHANGE THE CLUTCH (OR PARTS OF THE CLUTCH), LINKS, V-BELT ETC. SEE THE ATTACHED CHART FOR SPECIFIC PART NUMBERS.

WARNING

FAILURE TO DO THIS WILL RESULT IN THE BLADE
TIP SPEED TO RUN IN EXCESS OF THE ANSI STANDARD.

THE MODIFICATION OF THESE DECKS IS NOT COVERED BY WARRANTY. CONSIDER THE COST OF THE CONVERSION BEFORE MODIFYING THE DECKS.

Cub Cadet

Power Equipment

1992 DECK CONVERSION CHART

42" MOWER (190-320-100)

ADAPTING TO TRACTORS SERIAL NUMBER 800,000 TO 821,059

WILL NOT ADAPT

44" MOWER (190-318-100)

ADAPTING TO TRACTORS SERIAL NUMBER 800,000 TO 821,059

MODEL NO.	190-318 44"	756-3007 PULLEY	703-0150 LINK	719-3008 LINK	711-3021 FERRULE	754-3003A V-BELT
1340	X	X	X	X	X	X
1535	X	X	X	X	X	X
1540	X	X	X	X	X	X
1541	X	X	X	X	X	X
1860	X	X	X	X	X	X
1861	X	X	X	X	X	X
1862	X	X	X	X	X	X

NOTE: REASSEMBLE THE IDLERS ON THE MULE DRIVE TO THE INSIDE POSITION.

46" MOWER (190-321-100)

ADAPTING TO TRACTORS SERIAL NUMBER 800,000 TO 821,059

MODEL NO.	190-321 46"	759-3652 PULLEY	719-3072 LINK	719-3008 LINK	711-3021 FERRULE [2]	754-3042B V-BELT (MULE)	754-3041 V-BELT (SPINDLE)
1340	N/A						
1535	X	X	X	X	X	X	X
1540	X	X	X	X	X	X	X
1541	X	X	X	X	X	X	X
1860	X	X	X	X	X	X	X
1861	X	X	X	X	X	X	X
1862	X	X	X	X	X	X	X

MODEL NO.	190-321 46"	759-3652 PULLEY	754-3041 V-BELT (SPINDLE)	190-332 ADAPTER
-----------	-------------	-----------------	---------------------------	-----------------

1782	X	X	X	X
1882	X	X	X	X
2082	X	X	X	X
2182	X	X	X	X

NOTE: REASSEMBLE THE IDLERS ON THE MULE DRIVE TO THE INSIDE POSITION.

54" MOWER (190-324-100)

ADAPTING TO TRACTORS SERIAL NUMBER 800,000 TO 821,059

MODEL NO.	190-324 54"	711-3338 COLLAR [2]	759-3602 ADAPTER
1782	X	X	X
1882	X	X	X
2082	X	X	X
2182	X	X	X

NOTE: REASSEMBLE THE IDLERS ON THE MULE DRIVE TO THE INSIDE POSITION.

60" MOWER (190-325-100)

ADAPTING TO TRACTORS SERIAL NUMBER 800,000 TO 821,059

MODEL NO.	190-325 60"	190-385 ADAPTER	HA-14241 PULLEY	754-3023 V-BELT	719-3010 LINK [2]	711-3021 FERRULE [2]
1782	X	X	X	X	X	X
1882	X	X	X	X	X	X
2082	X	X	X	X	X	X
2182	X	X	X	X	X	X

Cub Cadet**Power Equipment****1991 DECK CONVERSION CHART****38" MOWER (190-328-100)**

ADAPTING TO TRACTORS SERIAL NUMBER 821,101 & HIGHER

MODEL NO.	190-328 38"	717-3313 CLUTCH	717-3044 CLUTCH*	719-3092 LINK	719-3091 LINK	711-3319 FERRULE [2]	712-0239 HEX NUT [2]
1440	X	X		X	X	X	X
1641	X	X		X	X	X	X
1861	X		X	X	X	X	X
1862	X		X	X	X	X	X

* ONLY NECESSARY TO CHANGE 759-3304 ARMATURE & 759-3305 DRUM BRAKE

44" MOWER (190-358-100)

ADAPTING TO TRACTORS SERIAL NUMBER 821,101 & HIGHER

MODEL NO.	190-358 44"	717-3313 CLUTCH	717-3044 CLUTCH*	603-0040 LINK	719-3091 LINK	711-3319 FERRULE	712-0239 HEX NUT
1440	X	X		X	X	X	X
1641	X	X		X	X	X	X
1861	X		X	X	X	X	X
1862	X		X	X	X	X	X

* ONLY NECESSARY TO CHANGE 759-3304 ARMATURE & 759-3305 DRUM BRAKE

46" MOWER (190-336-100)

ADAPTING TO TRACTORS SERIAL NUMBER 821,101 & HIGHER

MODEL NO.	190-336 46"	717-3313 CLUTCH	717-3044 CLUTCH*	719-3092 LINK	719-3091 LINK	711-3319 FERRULE [2]	712-0239 HEX NUT [2]	754-3042B V-BELT
1440	N/A							
1641	X	X		X	X	X	X	X
1861	X		X	X	X	X	X	X
1862	X		X	X	X	X	X	X

MODEL NO.	190-336 46"	717-3313 CLUTCH	717-3043 CLUTCH*	719-3103 LINK	719-3104 LINK	711-3319 FERRULE [2]	712-0239 HEX NUT [2]	754-3043 V-BELT
1782	X	X		X	X	X	X	X
2082	X		X	X	X	X	X	X
2182	X	X		X	X	X	X	X

* ONLY NECESSARY TO CHANGE 759-3303 ARMATURE & 759-3303 DRUM BRAKE

50" MOWER (190-359-100)

ADAPTING TO TRACTORS SERIAL NUMBER 821,101 & HIGHER

MODEL NO.	190-359 50"	717-3313 CLUTCH	717-3044 CLUTCH*	603-0040 LINK	719-3091 LINK	711-3319 FERRULE	712-0239 HEX NUT
1440	X	X		X	X	X	X
1641	X	X		X	X	X	X
1861	X		X	X	X	X	X
1862	X		X	X	X	X	X

MODEL NO.	190-359 50"	717-3313 CLUTCH	717-3044 CLUTCH*	719-3092 LINK	719-3091 LINK	711-3021 FERRULE [2]
1782	X	X		X	X	X
1882	X		X	X	X	X
2082	X		X	X	X	X
2182	X	X		X	X	X

* ONLY NECESSARY TO CHANGE 759-3304 ARMATURE & 759-3305 DRUM BRAKE

60" MOWER (190-374-100)

ADAPTING TO TRACTORS SERIAL NUMBER 821,101 & HIGHER

MODEL NO.	190-374 60"	190-319 ADAPT KIT	759-3656 ADAPT KIT
1782	X	X	X
2082	X	X	X
2182	X	X	X

NOTE: IT MAY BE NECESSARY TO GRIND THE UNDERCARRIAGE NEXT TO THE DECK PULLEY FOR ADDITIONAL CLEARANCE FOR THE V-BELT

INSTALLATION

A. FRONT HANGER ASSEMBLY PREPARATION

Refer to Figure 2 and proceed as follows.

1. Remove adjusting rod (7) and flat washer (8) from hanger assembly (9).
2. Remove pulley (10) and ratchet arm (11) from RH idler arm (4).
3. Remove E ring (1) from shaft (2) on side shown in Figure 2 and slide shaft (2) out of hanger assembly (9).
4. While sliding shaft (2) out, remove spring (3), RH idler arm (4), two spacers (5) and LH idler arm and pulley assembly (6).

Refer to Figure 3 and reassemble front hanger assembly (9) in the following order:

5. Slide shaft (2) into front hanger assembly (9).

6. Assemble one spacer (5) (removed in step 4), LH idler arm assembly (6), RH idler arm assembly (4) and spring (3) onto shaft (2).
7. Insert tang of spring (3) into long slot on frame as shown in Figure 3.
8. Assemble shaft (2) to front hanger assembly (9) with E-ring (1).
9. Insert adjusting rod (7) with flat washer (8) through inside hole on frame and assemble to threaded female on LH idler arm assembly (6).
10. Remount pulley (10) on RH idler arm assembly (4). Position ratchet arm (11) through inside slot on frame as shown in Figure 3.
11. Resecure ratchet arm (11) to pulley (10) with nut and washers.

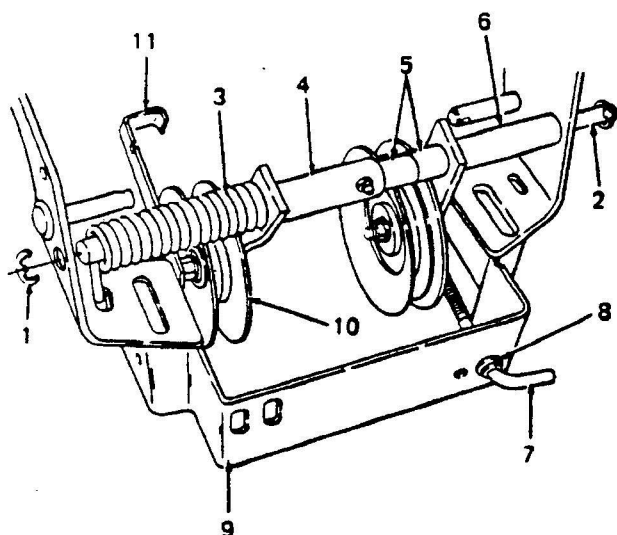

Figure 2

1. E-Ring
2. Pivot Shaft
3. Spring
4. RH Idler Arm
5. Spacer
6. LH Idler Arm Assembly
7. Adjusting Rod
8. Flat Washer
9. Front Hanger Assembly
10. Pulley
11. Ratchet Arm

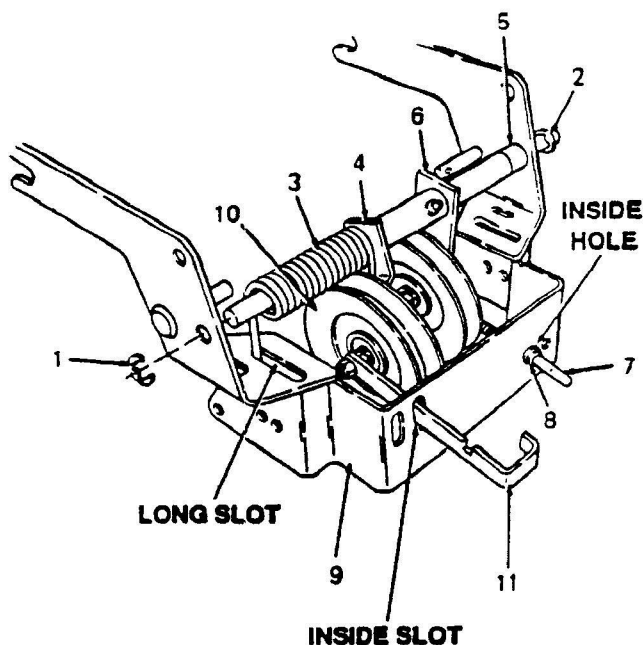

Figure 3

1. E-Ring
2. Pivot Shaft
3. Spring
4. RH Idler Arm Assembly
5. Spacer
6. LH Idler Arm Assembly
7. Adjusting Rod
8. Flat Washer
9. Front Hanger Assembly
10. Pulley
11. Ratchet Arm